

Made in Germany

NEW !

HAFF & SCHNEIDER

3D-TASTER

waterproof with measurement calibration

Alignment and positioning in all three axes

An indispensable accessory for all NC-machines, machining centers and EDM machines.

Cost reduction and increased productivity through shorter machine down-times

- Precise performance
- Compact construction
- Sturdy casing
- Outstanding shock-proof quality
- Splash proof
- Especially easy radial run-out compensation

New dial:

Find your exact zero points in all three axes in seconds with the new distance measuring scale (graduated and analogue).

- Black scale for radial deflection
- Red scale for axial deflection

- Precise and effortless caliper of fixtures and workpiece edges
- Setting of NC-programme zero points in seconds
- Measuring of clamped workpieces
- Generous overrun allowances prevent damage to Taster stylus
- Easy and precise change of stylus



3D-TASTER

Forget your confusion about plus and minus. No matter from which direction you approach: the zero point is determined at the first attempt with constant and exact information on the difference value.

- High accuracy: $\pm 0,01\text{mm}(0.004\text{'})$.
- Generous overrun allowances: radial 12mm(0.47").
- Simple and exact radial run-out compensation.
- Electrically insulated contact point, therefore also suitable for EDM machines.
- Very sturdy, dial fully integrated into the metal housing.
- Active shock-protection.
- Splash proof.
- Predetermined breading point at stylus prevents collision damages.

359100 3D-Taster	
Clamping shank	20mm(0.8"), ϕ h5
Accuracy	0,01 mm(0.004 ")
Graduation of scale	0,01mm(0,004")
Total length(with standard stylus, without clamping shank)	123mm(4.84")
Dial ϕ	50mm(2")

Change stylus in seconds

- No screws or special tools required
- Easy precision plug-in mechanism

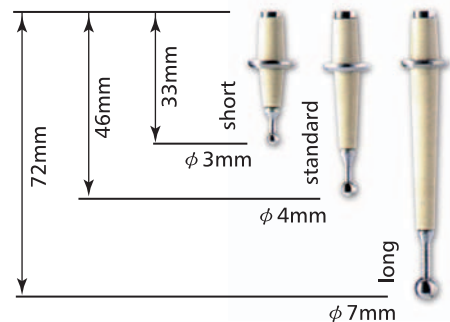

Unmistakable values indicated by single-needle system with scales in different colours.

- Radial approach : black scale



1. The stylus touches the workpiece, the difference value spindle axis /workpiece edge can be read(example:-0,44mm).



2.Zero position has been reached, spindle axis= workpiece edge: The NC-control can be set to "Zero"

For both radial and axial calipering the exact difference value is precisely and easily readable.

- Axial approach : red scale



1. The stylus touches the workpiece surface. The difference value can be read (example:0,08mm).



2. Zero position has been reached. The effective total length of 3D-Taster has been preset; the NC-control can be set to "Zaro".

Styluses for 3D-Taster:

Styluses are self-centering by taper socket.

Applications:

Short stylus for retracted spaces, long stylus for deep-seated edges.

359120 short stylus
359180 standard stylus
359220 long stylus

always better

The advertisement features a background image of a laser coolant pointer being used on a machine's spindle. A hand holds the device, which emits a red laser beam onto the drill bit. In the top right corner, a circular inset shows the device's components: a main body, a laser head, and four different sizes of link sticks. The model number 'LCP100' is printed on the inset. The main title 'REVA Laser Coolant Pointer' is prominently displayed in blue and white text. A red-bordered box contains the text 'Promotion Offer!'. Below the title, there are three paragraphs of descriptive text and a bulleted list of features. A box at the bottom left contains the model ID and a list of standard accessories. The bottom of the page has a blue banner with contact information.

REVA[®]

Laser Coolant Pointer

Promotion Offer !

Set the coolant jet in dry by REVA Laser Coolant Pointer!

The Laser Coolant Pointer is applied on the machines where you need to adjust the coolant jet nozzle of the spindle.

Laser Coolant Pointer helps operator to set the direction of the nozzle before switch on the coolant pump. The laser beam is instead of the actual coolant jet to indicate the target of the coolant jet to be set.

It avoids the coolant jet spread out of the machine. Keep the environment clean and dry, makes operator happy to adjust the coolant jet nozzle. Make it clean and dry, even the machine door is open.

- Safe
- Easy Handling
- Accuracy
- Time Saving

Model ID: LCP100 Laser Coolant Pointer

Standard Accessories:

- Laser Pointer Body and Laser Head
- Four different sizes adjust link stick.
- 1.5V Battery x 3 pcs.

If you need any further information, please feel free to contact us.

Electronic Edge Finder

For Setting Work Coordinate on Machining Centers .
Diameter of probe: $\phi 10$ mm

High Accuracy
Low Cost
Easy Handling
Safe

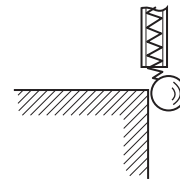
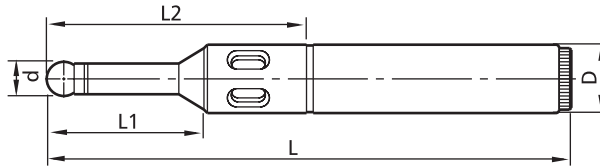

Safety Design.



Features:

- Accuracy of ball: ± 0.002 mm
- Concentricity of ball-probe and shank: 0.005 mm
- Spring loaded ball-probe for preventing damage of probe.

Ordering Code	Type	D	d	L	L1	L2	Beeper
0-302630-201	EEF-2010	20	10	160	50	85	X
-201B	SOE-2010B	20	10	158	50	85	Beeper
-604	EEF-3404	3/4"	0.4"	6"	1.80"	3.00"	X
-321	-3210	32	10	160	50	85	X

Battery: 2x 1.5V

Rotary-Edge Finder

For Setting Work Coordinate on Machining Centers and Milling Machine .

High Accuracy/Easy Handling/Low Cost

Ordering Code	Type	L	Shank	Probe
0-302630-301	REF-1010	82	10	10
-303	REF-1004	90	10	4

step1

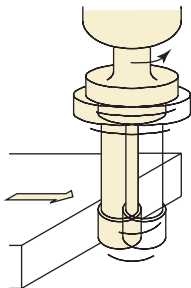

Spindle runs about 500 rpm.
Move spindle closed to measuring surface.

Measuring speed: 500rpm.

step2

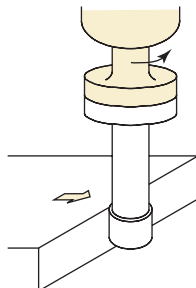

When measuring probe touches workpiece, it looks like one part.

step3

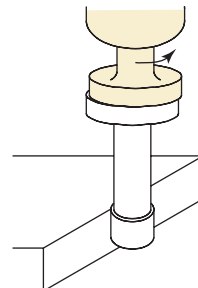

When the probe and shank are in alignment, probe will slide out of rotating center. Now, the center spindle is located 5mm away from measuring surface.

500rpm

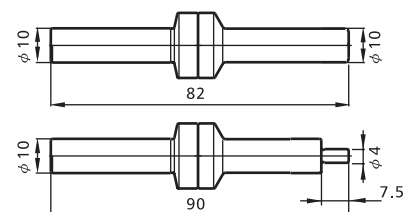
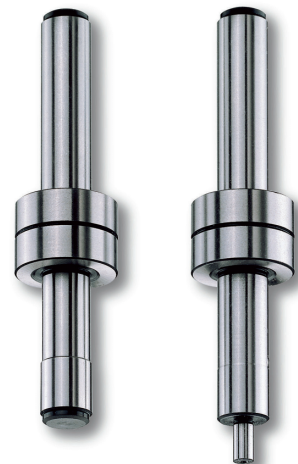

TP-300R

Standard Accessories

- BT50 # Test arbor
- Measuring Scale : Optical Scale
- Digital readout
- Dial Gauge: 2 pcs
- Cabinet (L x W x H) : 700 x 500 x 760
- Dust cover
- Wrench : 1 set

Optional Accessories

- BT30 # Test arbor
- BT40 # Test arbor
- BT30 # Sleeve
- BT40 # Sleeve
- RS-232 interface & specified software
- Air lock of tool shank

Length mm	Measuring range	X: axiz mm	Y: axiz mm	Optical Scale or LED Linear Scale	Tool Locking
50-400	300	0.001 (0.005)	0.001 (0.005)	X : 150 Y : 400	Handle
Projector	Power source	Machine net weight		Cabinet net weight	Packing size (mm)
-	110 / 220 V	145 kgs (100)		57 kgs (100)	1200x1100x1800

- Any special specification can be requested.
- All specifications and designs are subject to change without notice.



TP-300R

TP-300H

Standard Accessories

- BT50 # Test arbor
- Measuring Scale : Optical Scale
- Digital readout
- Dial Gauge: 2 pcs
- Dust cover
- Wrench : 1 set

Optional Accessories

- BT30 # Test arbor
- BT40 # Test arbor
- BT30 # Sleeve
- BT40 # Sleeve

Length mm	Measuring range	X: axiz mm	Y: axiz mm	Optical Scale or LED Linear Scale	Tool Locking
50-400	300	0.005	0.005	X : 150 Y : 400	-
Projector	Power source	Machine net weight		Cabinet net weight	Packing size (mm)
-	110 / 220 V	90 kgs		-	950x500x1070

- Any special specification can be requested.
- All specifications and designs are subject to change without notice.



TP-300H

always better

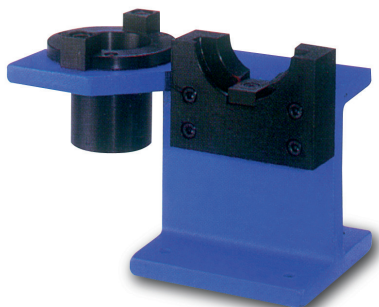
Universal Tool Looking Stand

Features:

- Set tools either horizontally or vertically simultaneously.
- Setting NC tooling easily and efficiently.
- Low cost and great value.

Ordering Code	Type	Taper
0-381020-130	TLS-30	ISO30
-140	TLS-40	ISO40
-150	TLS-50	ISO50

Tool Locking Fixture

Features:

- Easy handling and low cost tool locking fixture on work bench for preparing tools for machining centers.
- Swivel in vertical and horizontal.

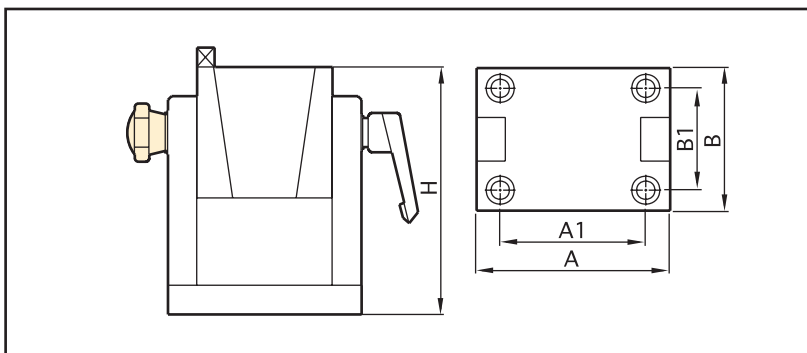

Ordering Code	Type	Taper	H	A	A1	B	B1
0-381010-30	TBS-30	ISO30	120	180	80	80	60
-40	TBS-40	ISO40	130				
-50	TBS-50	ISO50	170	133	100	98	70