

- Case hardened steel guarantees long operating life and elasticity of collets.
- All collets are precisely ground according to DIN 6499 class1 for high precision tool holding.
- Ordering Code: 0-300100 for class2 , 0-300101 for class 1
- New coolant type is available on request.



always better

ER11		ER20		ER25		ER32		ER40	
Ordering Code	Range (mm)	Ordering Code	Range (mm)	Ordering Code	Range (mm)	Ordering Code	Range (mm)	Ordering Code	Range (mm)
0-300100-201	1.0-0.5	0-300100-402	2-1	0-300100-502	2-1	0-300100-603	3-2	0-300100-704	4-3
-251	1.5-1.0	-403	3-2	-503	3-2	-604	4-3	-705	5-4
-202	2.0-1.5	-404	4-3	-504	4-3	-605	5-4	-706	6-5
-252	2.5-2.0	-405	5-4	-505	5-4	-606	6-5	-707	7-6
-203	3.0-2.5	-406	6-5	-506	6-5	-607	7-6	-708	8-7
-253	3.5-3.0	-407	7-6	-507	7-6	-608	8-7	-709	9-8
-204	4.0-3.5	-408	8-7	-508	8-7	-609	9-8	-710	10-9
-254	4.5-4.0	-409	9-8	-509	9-8	-610	10-9	-711	11-10
-205	5.0-4.5	-410	10-9	-510	10-9	-611	11-10	-712	12-11
-255	5.5-5.0	-411	11-10	-511	11-10	-612	12-11	-713	13-12
-206	6.0-5.5	-412	12-11	-512	12-11	-613	13-12	-714	14-13
-265	6.5-6.0	-413	13-12	-513	13-12	-614	14-13	-715	15-14
-207	7.0-6.5			-514	14-13	-615	15-14	-716	16-15
				-515	15-14	-616	16-15	-717	17-16
				-516	16-15	-617	17-16	-718	18-17
ER16						-618	18-17	-719	19-18
0-300100-301	1-0.5					-619	19-18	-720	20-19
-302	2-1					-620	20-19	-721	21-20
-303	3-2							-722	22-21
-304	4-3							-723	23-22
-305	5-4							-724	24-23
-306	6-5							-725	25-24
-307	7-6							-726	26-25
-308	8-7								
-309	9-8								
-310	10-9								

Collet Dimensions

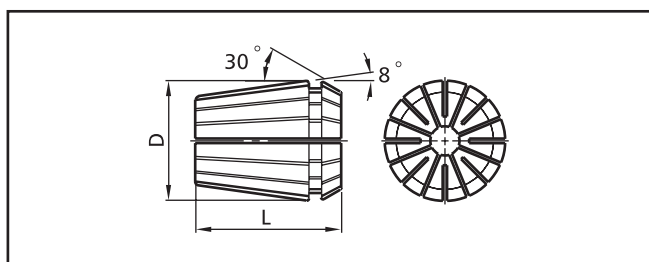

Concentricity of Collet DIN 6499

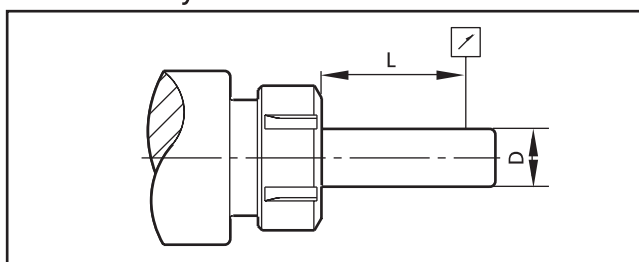

Type	ER11	ER16	ER20	ER25	ER32	ER40
D	11.5	17	21	26	33	41
L	18	27	31	35	40	46

L(mm)	D(mm)	class 2	class 1
		0-300100	0-300101
6	1.0- 1.4	0.015	0.01
10	1.5- 2.9		
16	3.0- 5.9		
25	6.0- 9.9		
40	10.0-17.9	0.02	0.015
50	18.0-26.9		
60	27.0-34.9		

Spring Collet Set

SPECIAL NOTE :

- Wooden box or wooden tray is not included, please order separately.
- Ordering Code : 0-300100 for class 2 , 0-300101 for class 1.



COLLET	Ording Code	Dimensions Of Collets In Each Set	Total Number Of Collets
ER11	0-300100-0207	1, 2, 3, 4, 5, 6, 7	7 pcs
	-0213	1, 1.5, 2, 2.5, 3, 3.5, 4, 4.5, 5, 5.5, 6, 6.5, 7	13 pcs
ER16	-0308	3, 4, 5, 6, 7, 8, 9, 10	8 pcs
	-0310	1, 2, 3, 4, 5, 6, 7, 8, 9, 10	10 pcs
ER20	-0410	4, 5, 6, 7, 8, 9, 10, 11, 12, 13,	10 pcs
	-0411	3, 4, 5, 6, 7, 8, 9, 10, 11, 12, 13	11 pcs
	-0412	2, 3, 4, 5, 6, 7, 8, 9, 10, 11, 12, 13	12 pcs
ER25	-0507	4, 6, 8, 10, 12, 14, 16	7 pcs
	-0515	2, 3, 4, 5, 6, 7, 8, 9, 10, 11, 12, 13, 14, 15, 16	15 pcs
ER32	-0606	6, 8, 10, 12, 16, 20	6 pcs
	-0618	3, 4, 5, 6, 7, 8, 9, 10, 11, 12, 13, 14, 15, 16, 17, 18, 19, 20	18 pcs
ER40	-0707	6, 8, 10, 12, 16, 20, 25	7 pcs
	-0715	4, 5, 6, 8, 10, 12, 13, 15, 16, 18, 20, 21, 22, 25, 26	15 pcs
	-0723	4, 5, 6, 7, 8, 9, 10, 11, 12, 13, 14, 15, 16, 17, 18, 19, 20, 21, 22, 23, 24, 25, 26	23 pcs

Set of Collets and Chuck

- The complete collet chuck set is supplied with wooden box(or plastic box)and spanner.



Ordering Code	Type	Collet Chuck	Collet set	Spanner
0-329100-0308	SBC20-ER16-100	0-329100-3240	0-300100-0308	0-301100-312
-1308	-150	-3260		
-0410	SBC20-ER20-150	0-329100-4260	0-300100-0410	0-301100-412
0-333100-0606	SNT30-ER32-6	0-333100-602	0-300100-0606	0-301100-612
-0618	-18		0-300100-0618	
0-343100-0606	SNT40-ER32-6	0-343100-602	0-300100-0606	
-0618	-18		0-300100-0618	
-0707	SNT40-ER40-7	0-343100-702	0-300100-0707	0-301100-712
-0723	-23		0-300100-0723	
0-359100-0606	SR8-ER32-6	0-359100-602	0-300100-0606	0-301100-612
-0618	-18		0-300100-0618	

always better